



This Project is  
**RERA**  
REGISTERED  
P52700047412

शहरातलं घर,  
गावच्या वाटेवर..



१२० उंबऱ्यांचं हवेशीर गांव



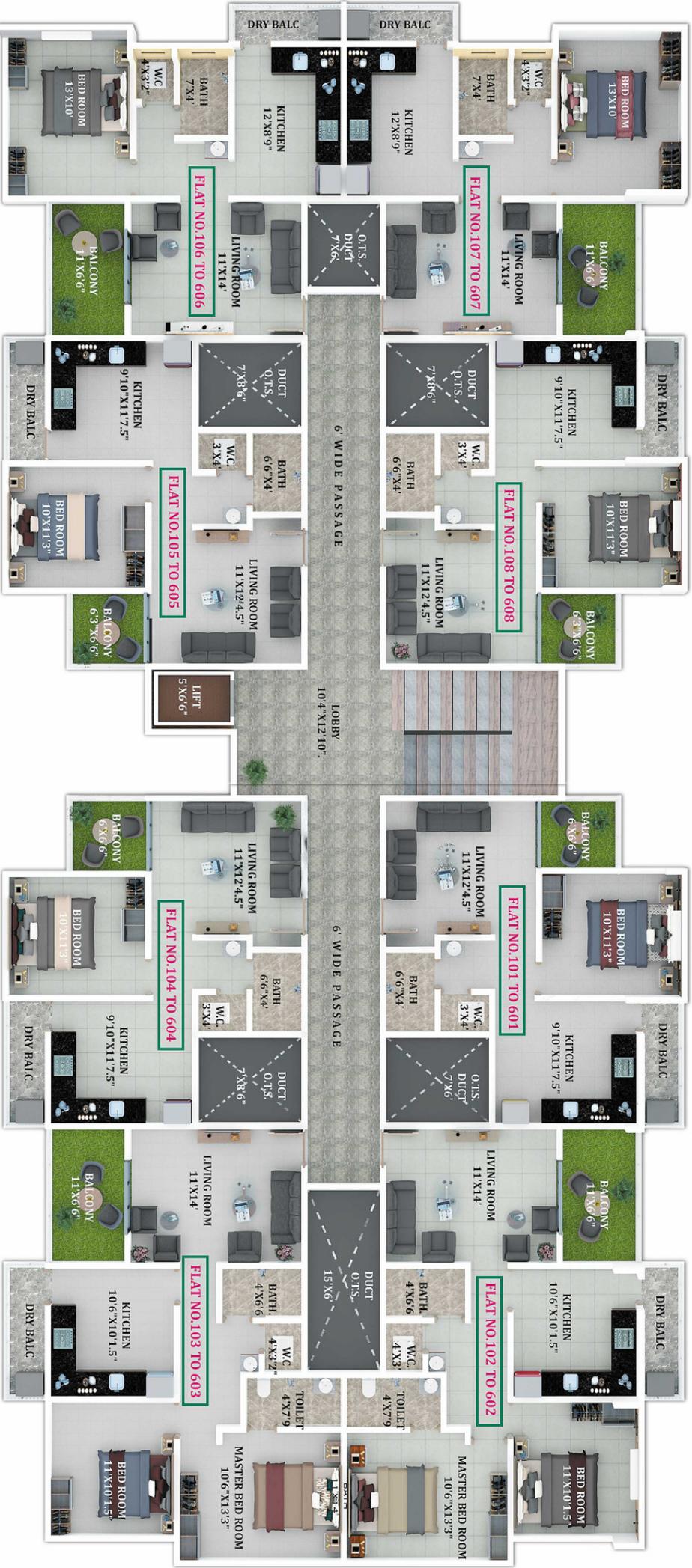

# PLAN WING A

TYPICAL FIRST, SECOND, THIRD, FOURTH, FIFTH & SIXTH FLOOR PLAN

Sr.No	Type	Flat Nos	Total Nos	Carpet Area as per RERA
1	1BHK	101-601, 104-604	12	556.29
2	2BHK	102-602, 103-603	12	808.81
3	1BHK	105-605, 108-608	12	555.1
4	1BHK	106-606, 107-607	12	618.93



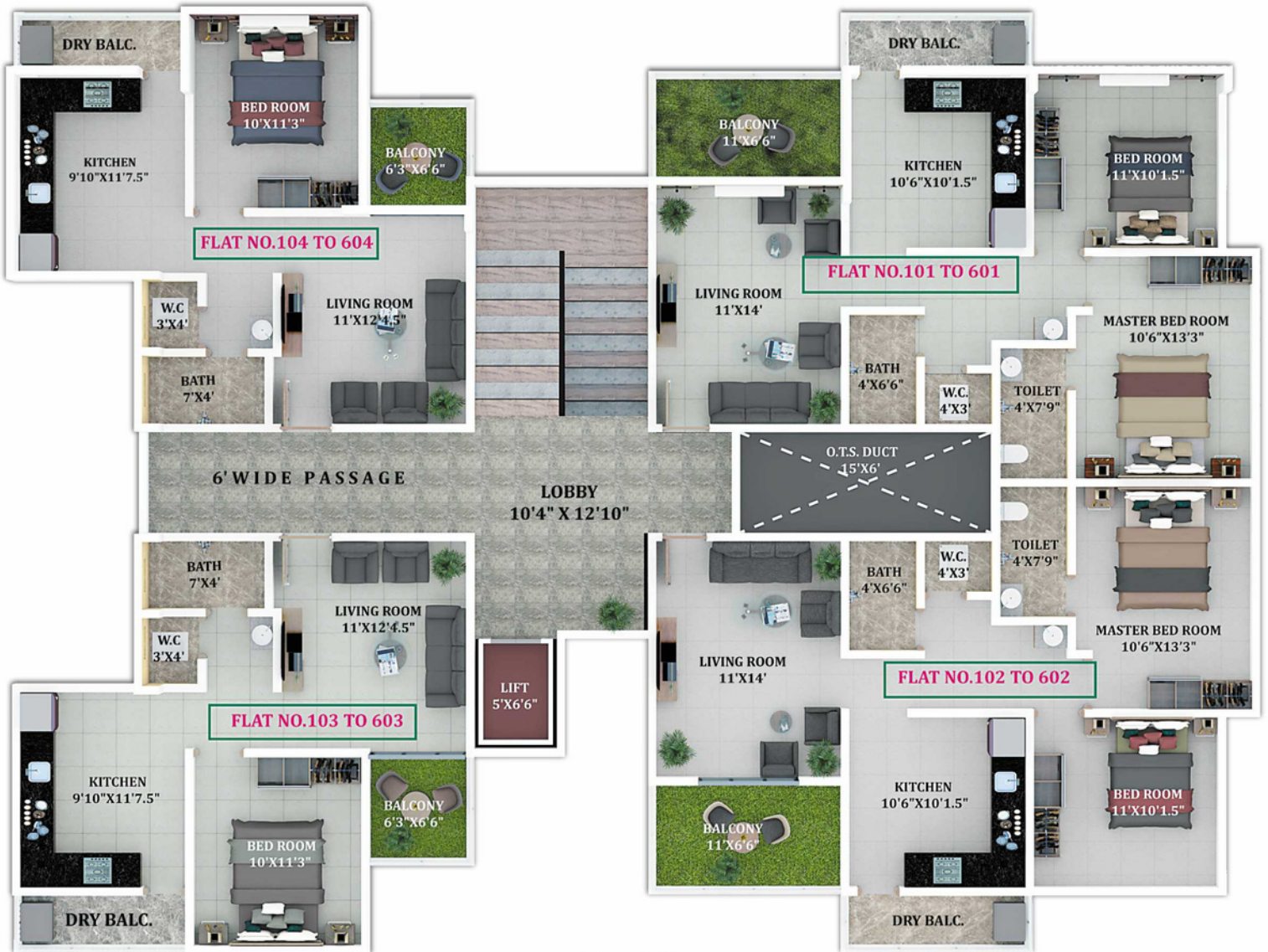

# PLAN WING B

TYPICAL FIRST, SECOND, THIRD, FOURTH, FIFTH & SIXTH FLOOR PLAN

Sr No	Type	Flat Nos	Total Nos	Carpet Area as per RERA
1	2BHK	101-601, 102-602	12	811.83
2	1BHK	103-603, 104-604	12	554.89

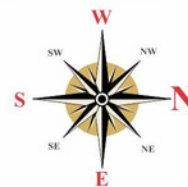

## AMENITIES



Security Gate with Security Guard Cabin



CCTV in Common Area.



Convenience Shops



Driver Lounge



Ample Parking Space



Landscape Garden with Temple, Children Play Area, Sitting Area.



Society Office



Rain Water Harvesting



## SPECIFICATIONS

### STRUCTURE

- R.C.C Earthquake Resistant Structure.

### MASONRY

- Int. 4" thick wall
- Ext. 6" thick wall

### PLASTERING

- External Sand Faced Plaster
- Internal Neeru Finish Plaster

### FLOORING

- Double Charged Vetrified Tiles for entire flat with skirting.
- Anti-Skid tiles for Terrace / Bathroom/Dry Balcony

### KITCHEN

- Standard Granite Kitchen Platform with Stainless steel sink
- Glazed tiles dado upto ceiling

### DOOR

- Main Door: Attractive Entrance Door
- Internal Door: Flush Door with Laminated Finish
- Toilet/ Bath: P.V.C Door
- M.S. French Door for Terrace with powder coating.

### LIFT

- I.S.I branded Lift with backup

### WINDOWS

- 3 Track Powder Coating Aluminium Sliding Window with Mosquito Net & M.S. Safety Grill.

### TOILET / BATH / W.C.

- Glazed tiles on the wall upto ceiling for Bath and Toilet & 4' ht. for W.C.
- Anti-Skid Ceramic Tiles for Toilet and Bath
- Standard I.S.I. Brand Sanitaryware

### WATER SUPPLY

- Through Three Underground Storage tanks & Over head water tanks

### ELECTRIFICATION

- Concealed Electric Fitting
- I.S.I Brand Modular Switches and Wiring

### PAINT

- Internal Oil Bond Distemper
- External Acrylic Paint

## EXTRA FEATURES

- A/C pt. in Master Bed ●
- Gyser & Exhaust pt. in bath and toilet ●
- Exhaust pt. & water purifier pt. in kitchen ●
- Washing machine pt. in dry balcony ●
- D.T.H & Broadband pt. in living room ●
- Circuit breaker in each flat ●
- Single Switch Safety Cut off for entire wing ●
- Maintenance valve for each Flat ●



**अभव  
शुद्धी**

# LOCATION

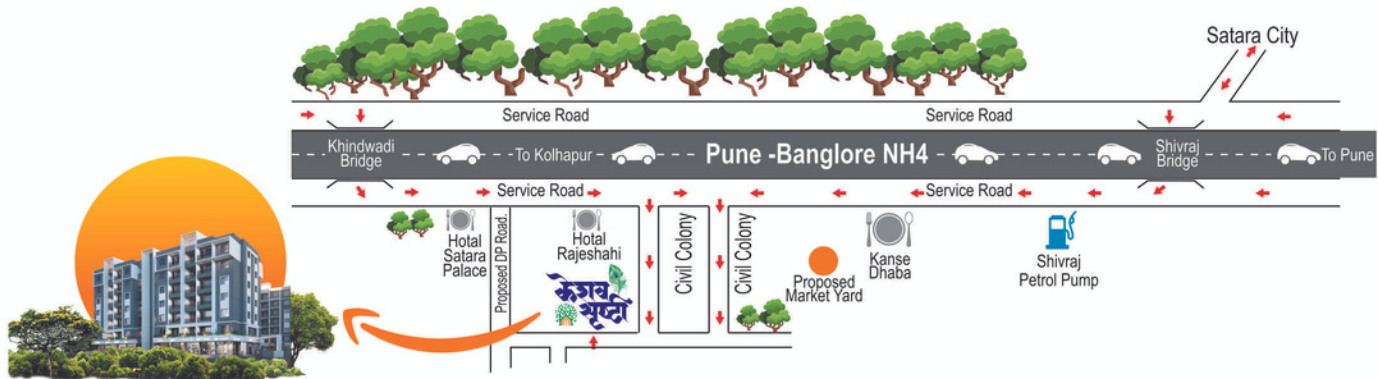

SCAN FOR DIRECTION

Site : PL. No.15+16, S.No. 5/6B, NH4, Civil Colony, Sambhaji Nagar, Satara

This Project is  
**RERA REGISTERED**



P52700047412

Member : **CREDAI**



in collaboration with



www.pramilaconstructions.com

**Abhishek Nikam** 9764999944



**Sunil Jadhav** 8600300015

R.C.C. Consultant  
**JANARDAN KADAM & ASSO.**  
9422400820

Architects  
**M.V.ASSOCIATES**  
9422039823

Legal Advisor  
**ADV. S. N. MAHAMULKAR**  
9422038617

A brochure is a imaginary concept of proposed building. Information contained in this brochure about amenities, furniture is indicative. The developers reserve a right to cancel or provide the said amenities in certain contingency.

VISION 9226124501



१२० उंबऱ्यांचं हवेशीर गांव

CLICK TO CONNECT US



Member : **CREDAI**



in collaboration with



Abhishek Nikam 📞 9764999944

BOOKING CONTACT

Sunil Jadhav 📞 8600300015